



SMITHGROUP JJR

University of Southern Indiana

Campus Master Plan
Board of Trustees Presentation
March 1, 2018

Master Planning Process

DISCOVERY



Discovery and Goal Setting

ANALYSIS



Space Analysis

Campus and Community Analysis

PLANNING



Idea Generation

Refinement

DOCUMENTATION

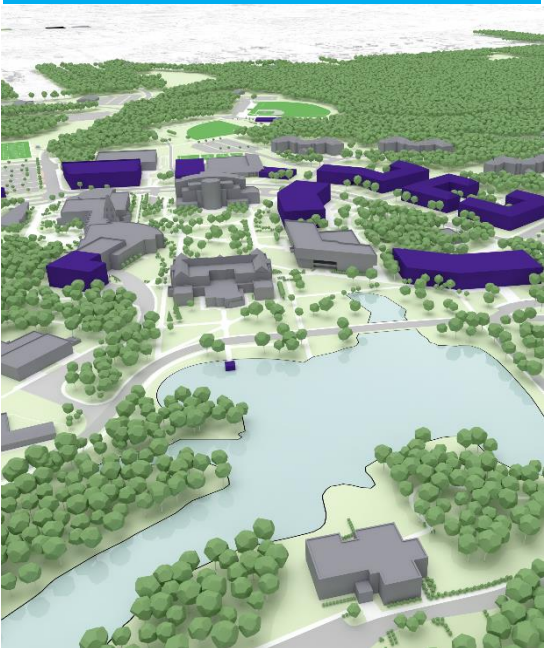

Documentation

It's Been a Great Year!



8
CAMPUS
VISITS



5
CAMPUS &
COMMUNITY
OPEN HOUSES



26
FOCUS
GROUP
MEETINGS



42
COMMITTEE
MEETINGS



6
STUDENT
FORUMS



1
INTERACTIVE
CAMPUS PLAN
WEBSITE

Strategic Plan + Enrollment Growth

2016-2020 Strategic Plan Goals:

- Excellence in Learning for the Entire USI Community
- Access and Opportunity by Design
- Purposeful and Sustainable Growth

Enrollment Growth:

- Total enrollment growth of nearly 14,000 students (33% increase).
- More than half of growth is expected to occur in online programs.

Campus-Wide Space Needs:

- Opportunity for increased classroom use. Based upon 30 Weekly Room Hours.
- Need for more Teaching Labs due to growth in Engineering and Biology.
- Increased space needed for campus study areas and student life spaces.

Space Needs by College:

- Growth in Romain College of Business and Pott College of Science, Engineering and Education due to enrollment increases.
- Improved space needed within College of Nursing and Health Professions.

Existing Campus

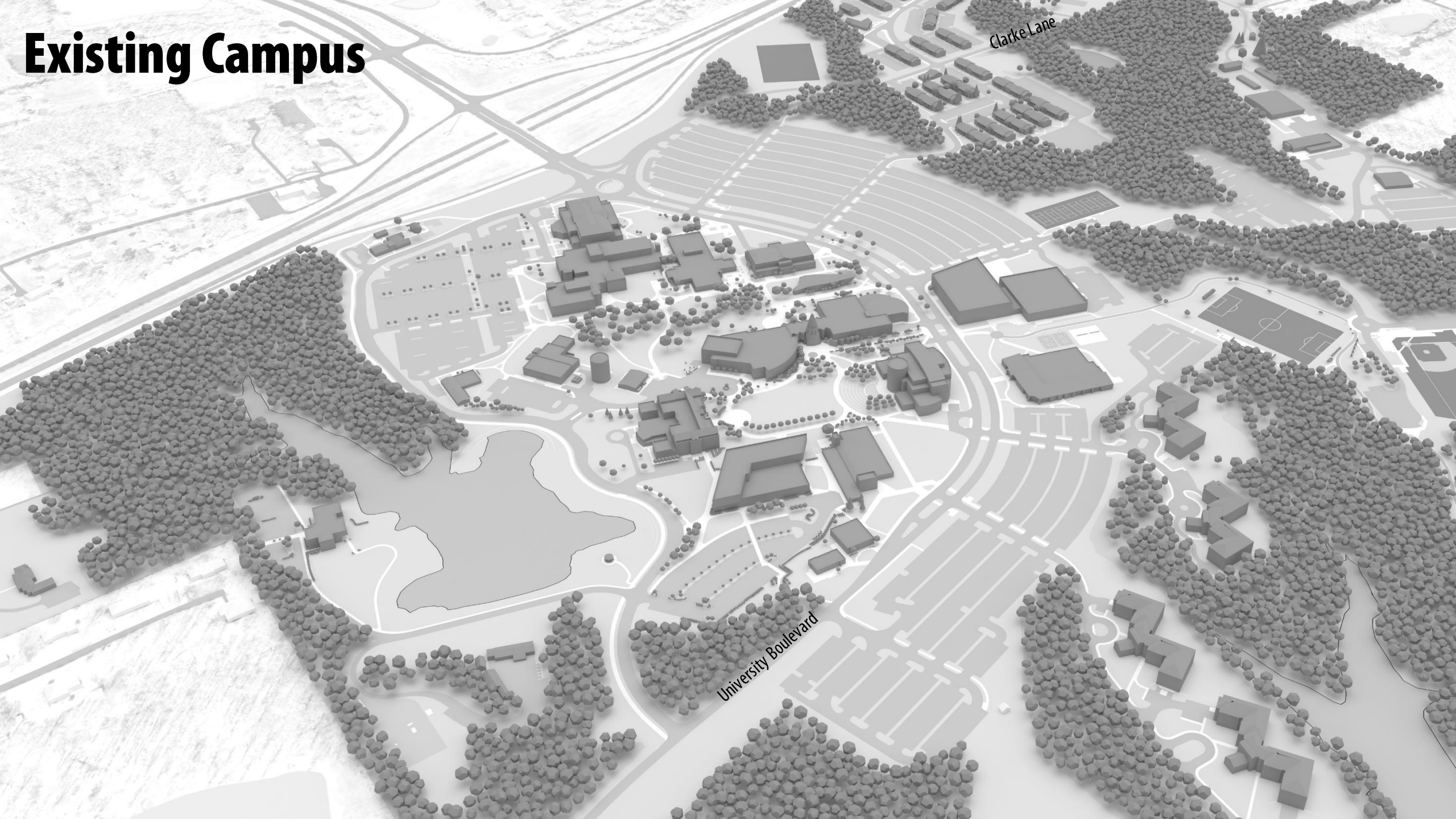

Vision

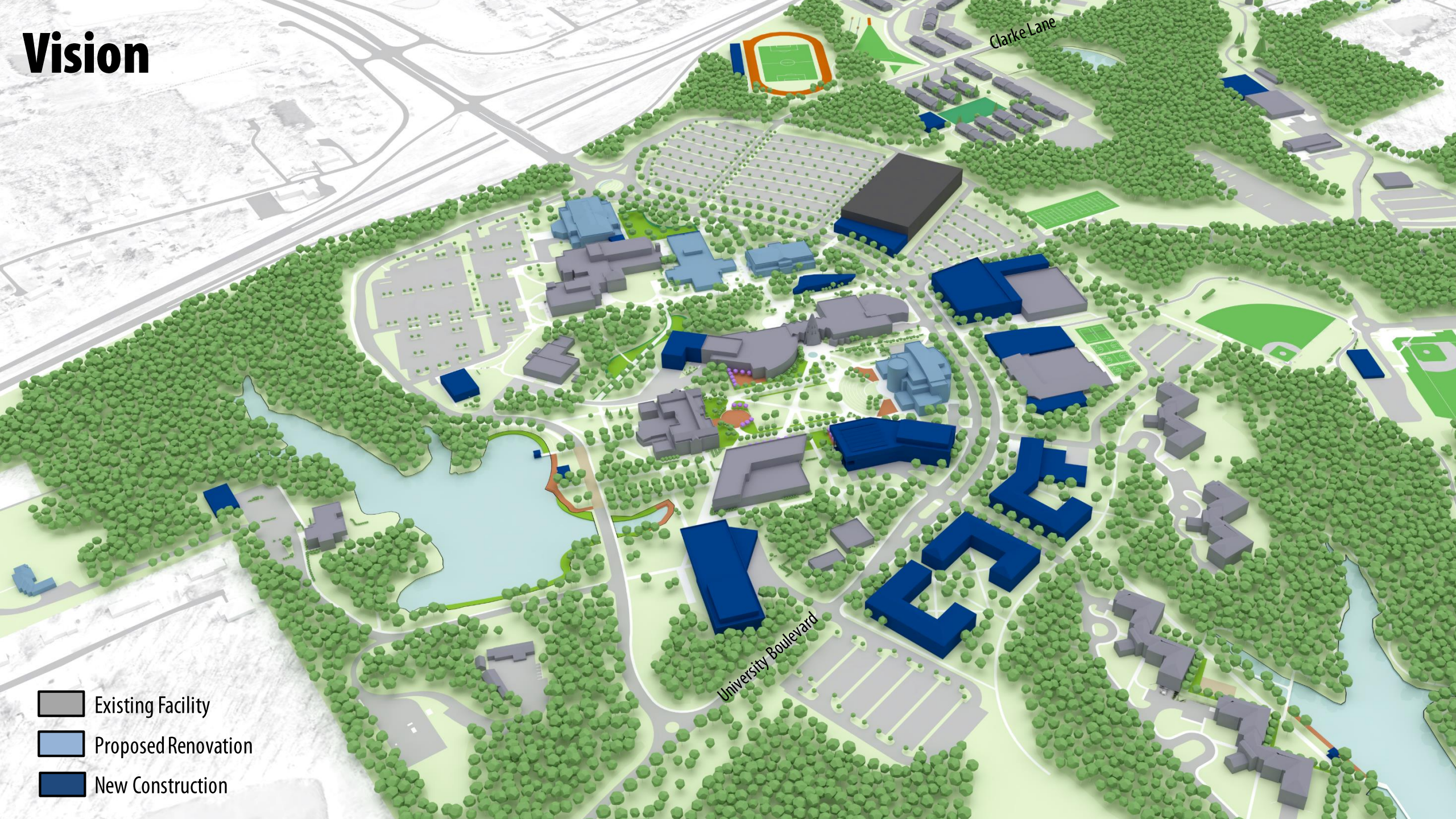

- Existing Facility
- Proposed Renovation
- New Construction

Vision

An aerial, 3D-rendered view of a university campus. The scene shows a mix of modern academic buildings in shades of blue and grey, interspersed with lush green trees and lawns. Several sports fields, including a baseball field and a soccer field, are visible. A large parking lot is situated in the lower-left quadrant. The overall atmosphere is one of a well-maintained, green campus environment.

Key Planning Themes

- 1 Enrich the Academic Experience
- 2 Transform Student Life
- 3 Celebrate Campus Spirit
- 4 Strengthen Campus Identity
- 5 Improve Support Facilities

Key Planning Themes

- Better utilize existing classrooms.
- Repurpose underutilized space for greater impact.
- Ensure technology is equitable across campus.
- Create uniform building condition.
- Transform Rice Library.

Enrich the Academic Experience

Enrich the Academic Experience

Proposed

- ① Renovate Health Professions
- ② Renovate Wright Admin/Forum Bldg
- ③ Orr Student Services Center
- ④ Rice Library Transformation
- ⑤ Nexus Innovation Center

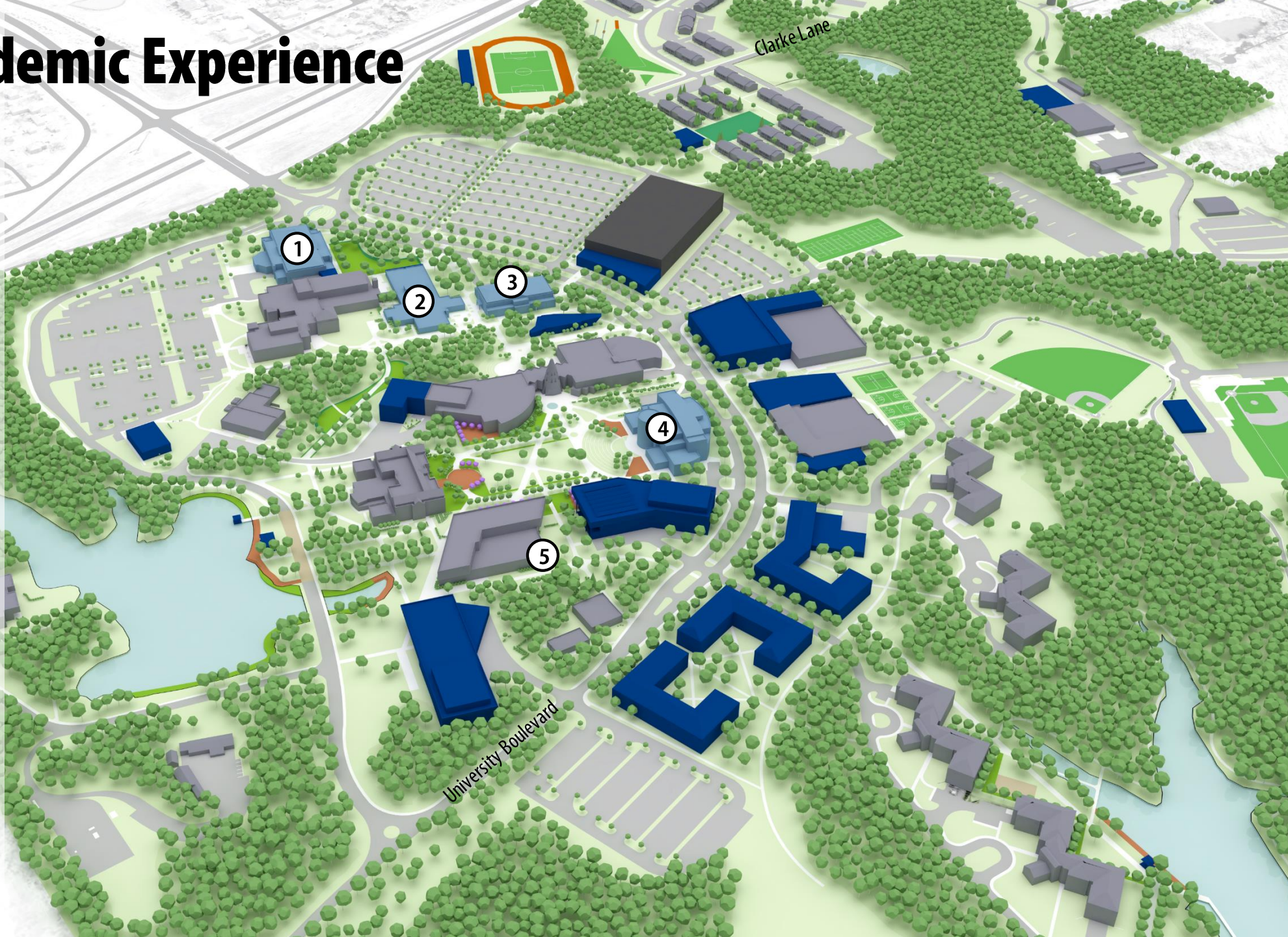

Nexus Innovation Center

Engineering

Nexus

Design

Business

Nexus Innovation Center

Business + Engineering + Design

Proposed



Key Planning Themes

- Balance the mix of apartments and suites.
- Increase the number of residential units.
- Expand dining options on-campus.
- Enhance available student amenities.
- Recast the University Center.

Transform Student Life

Transform Student Life

Proposed

- ① Housing + Dining Complex
- ② Health + Wellness Center
- ③ Create a Student Union
- ④ New Apartment Commons
- ⑤ Balance Apartment Mix

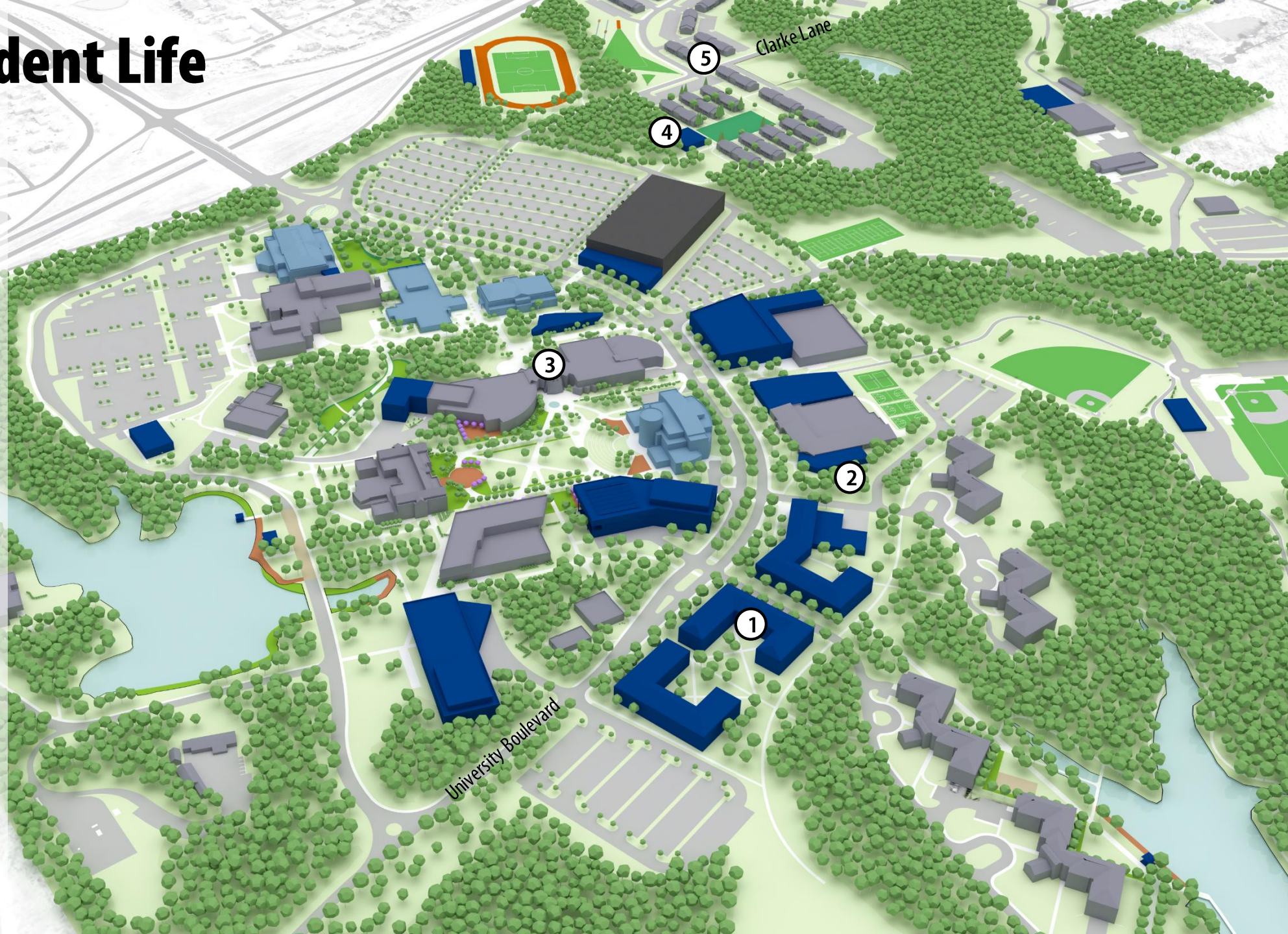

Student Housing + Dining Improvements

Develop Community Style Housing with Expanded Dining Options in the Campus Core



Gallaudet University



Miami University



Student Housing + Dining Improvements

Proposed

Convert and Refresh Existing Apartment Units

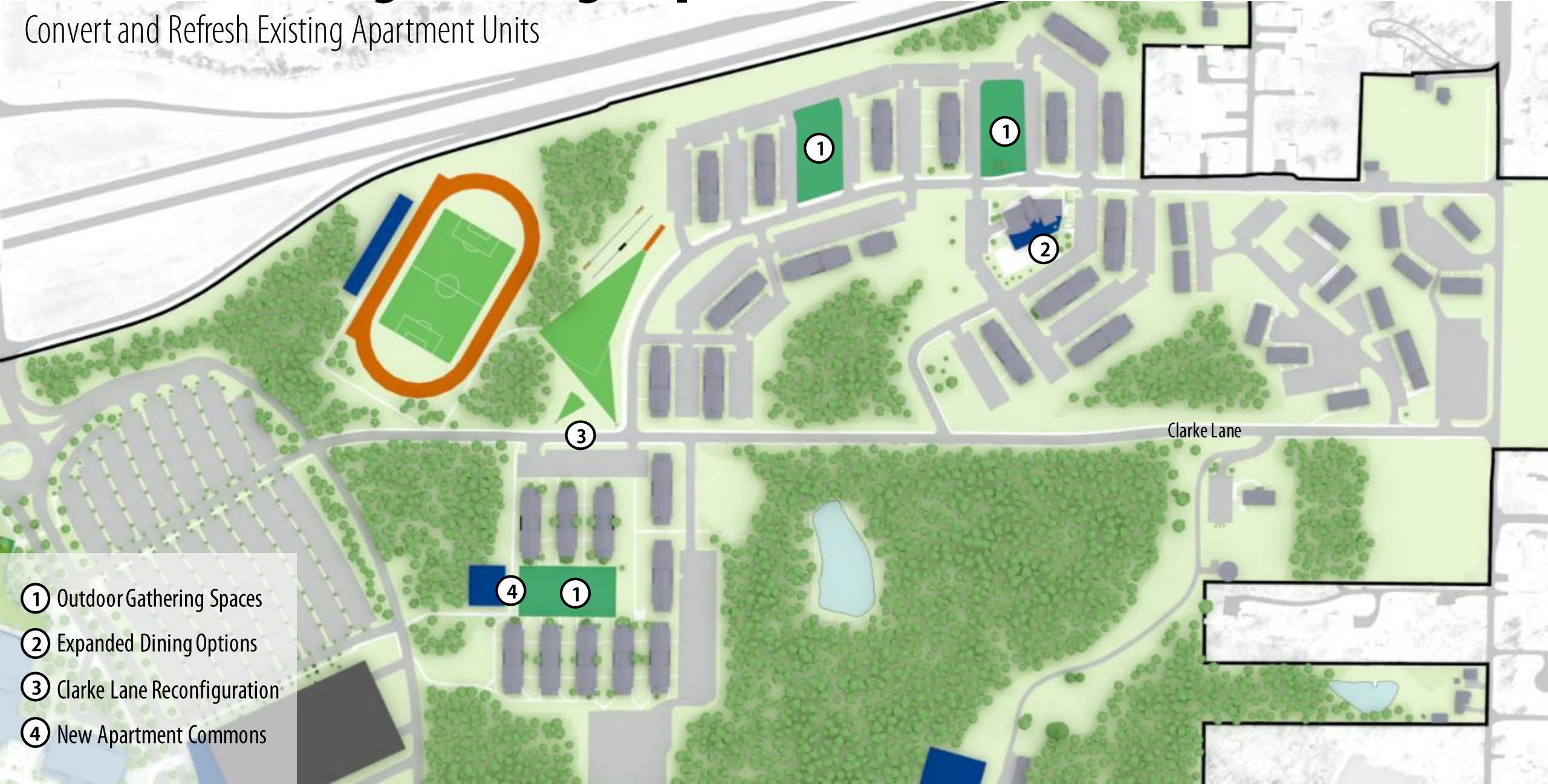

- ① Outdoor Gathering Spaces
- ② Expanded Dining Options
- ③ Clarke Lane Reconfiguration
- ④ New Apartment Commons

Key Planning Themes



- Encourage more on-campus living.
- Activate campus.
- Make athletics more visible with higher impact.
- Preserve and enhance recreation opportunities.

Celebrate Campus Spirit

Celebrate Campus Spirit

Proposed

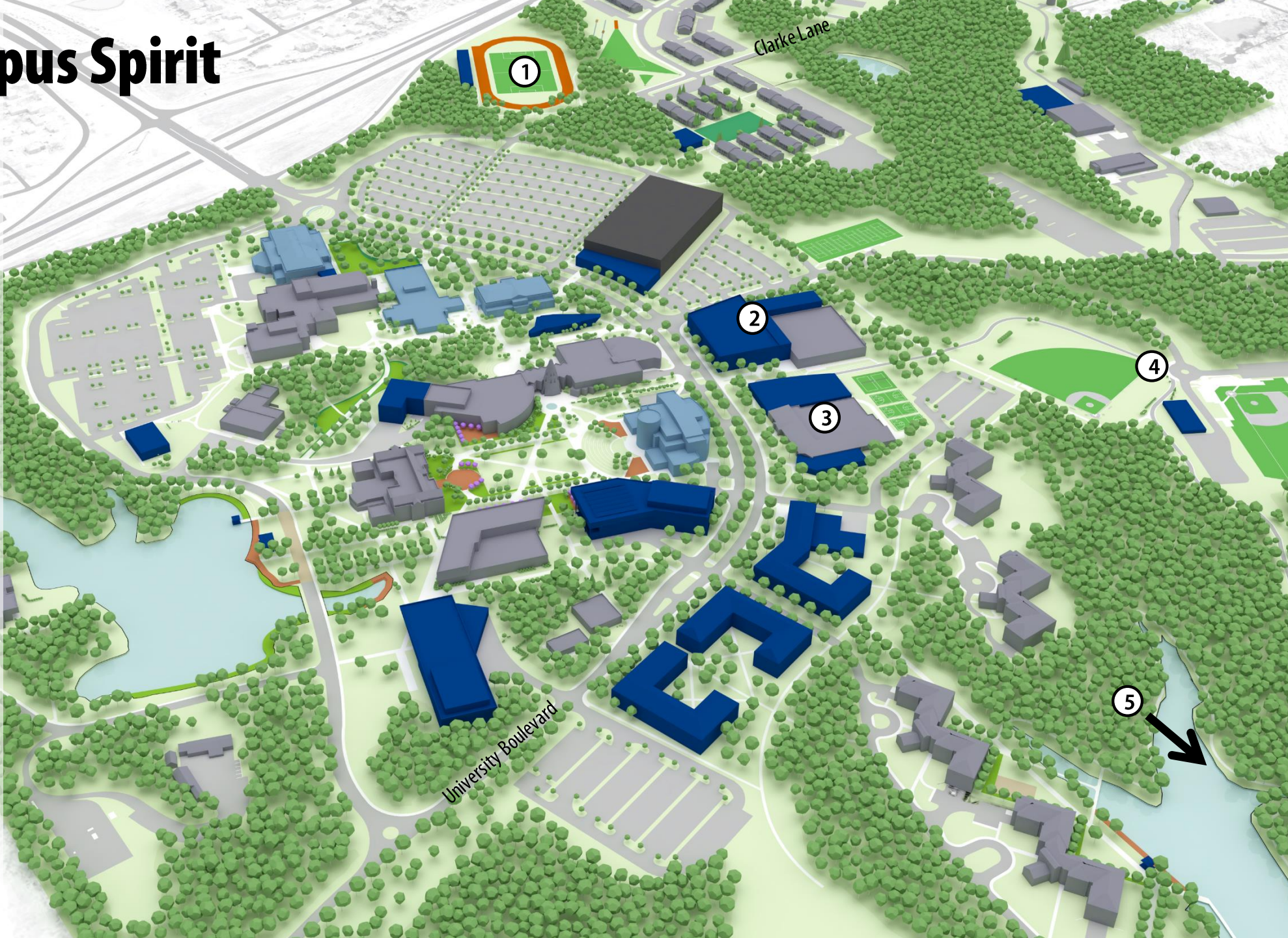

- ① Stadium for Soccer, Track and Field
- ② PACI & II Expansions
- ③ Aquatic Center Expansion
- ④ Baseball and Softball Center
- ⑤ Broadway Complex

Proposed

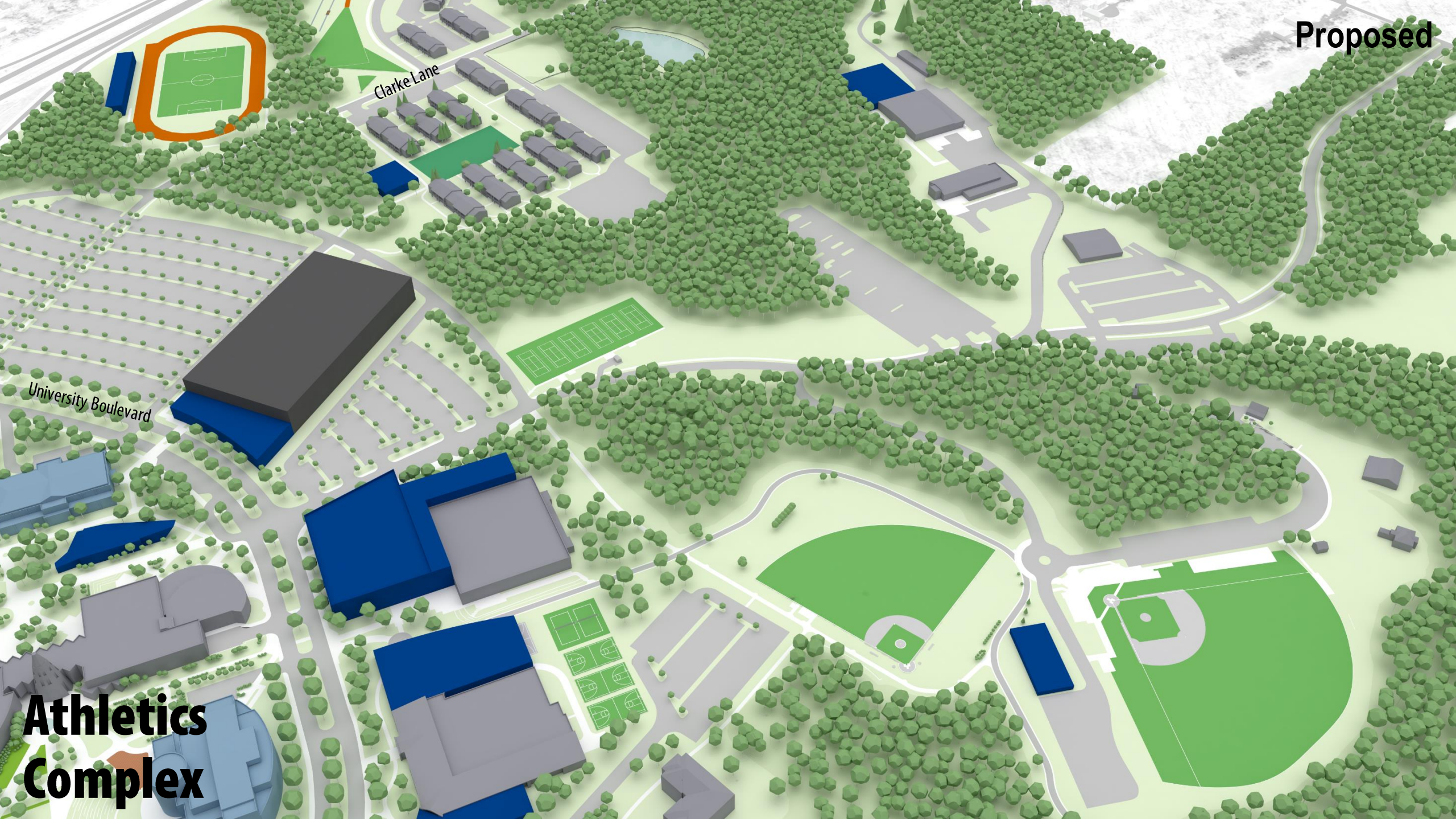

University Boulevard

Clarke Lane

**Athletics
Complex**

Broadway Complex

Proposed

- ① Soccer
- ② New Support Facility
- ③ Recreation Fields
- ④ Expanded Parking

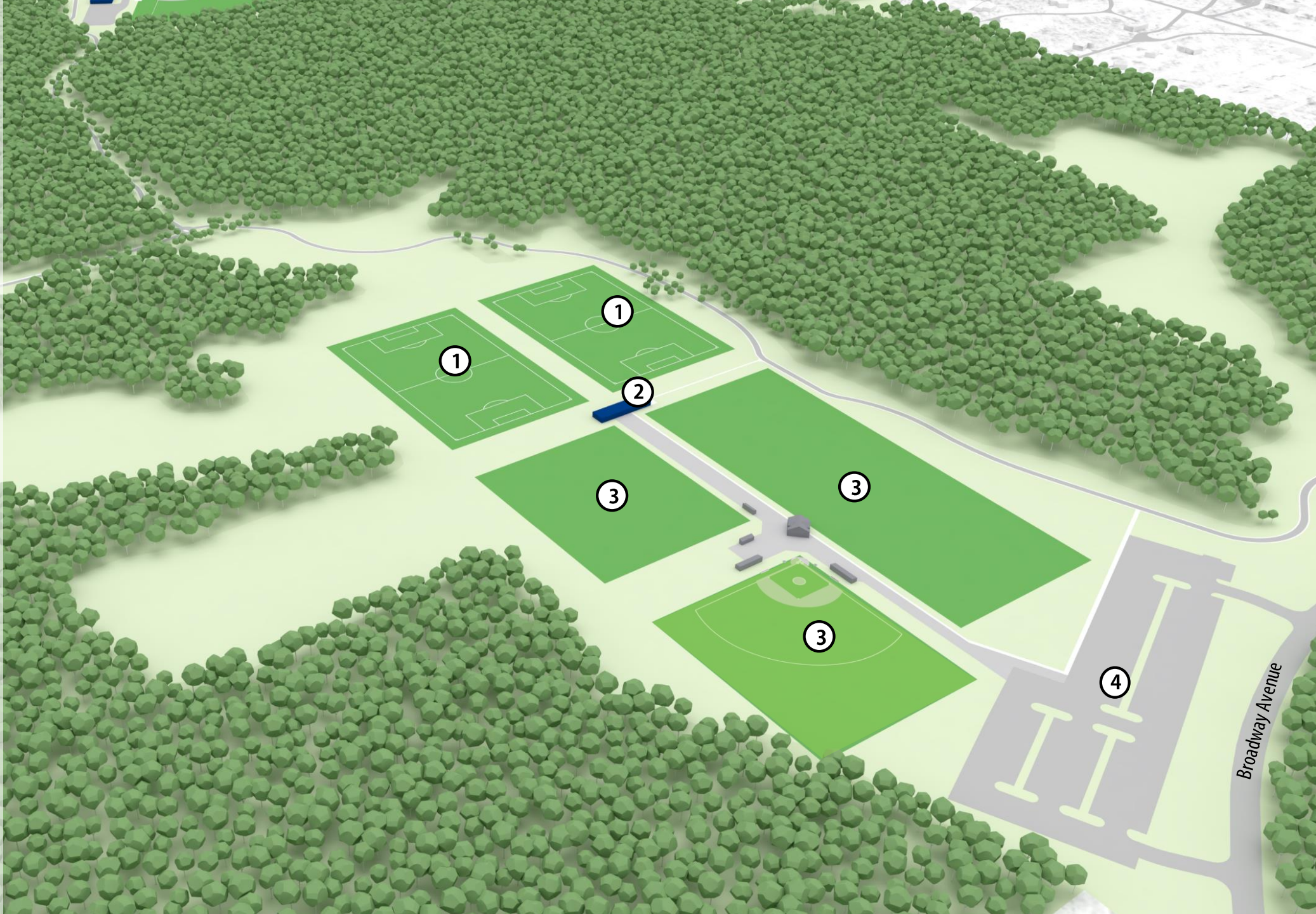

Key Planning Themes

- Improve campus wayfinding and signage.
- Develop a consistent palette of open spaces.
- Enhance campus-wide connectivity.
- Embrace natural features (lake, trees, topography).

Strengthen Campus Identity

Strengthen Campus Identity

Proposed

- ① Create a Signature Quad
- ② Enhance the Lake
- ③ Woodland Walkway
- ④ University Gateway Plaza
- ⑤ Apartment Outdoor Commons

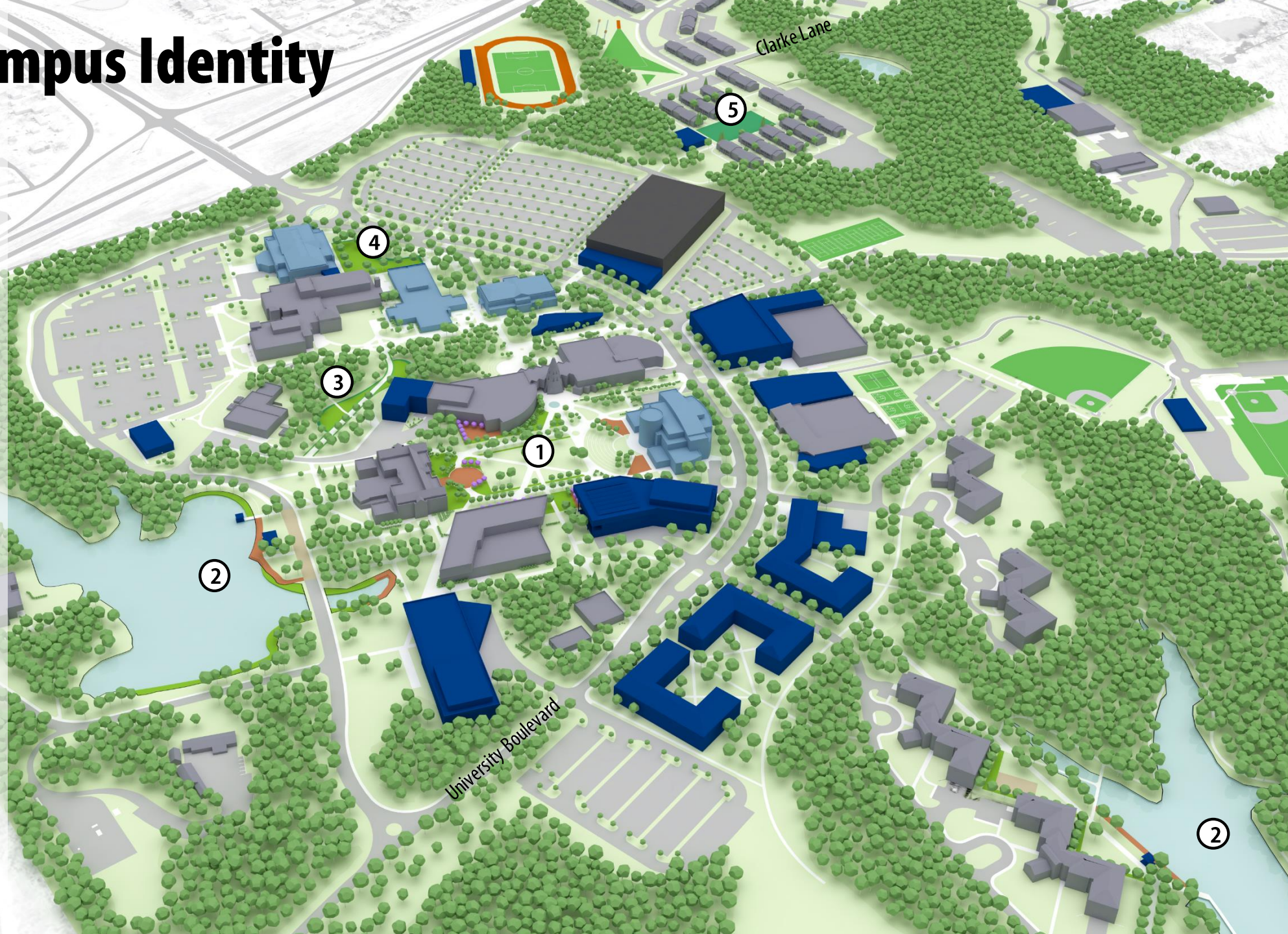

Existing

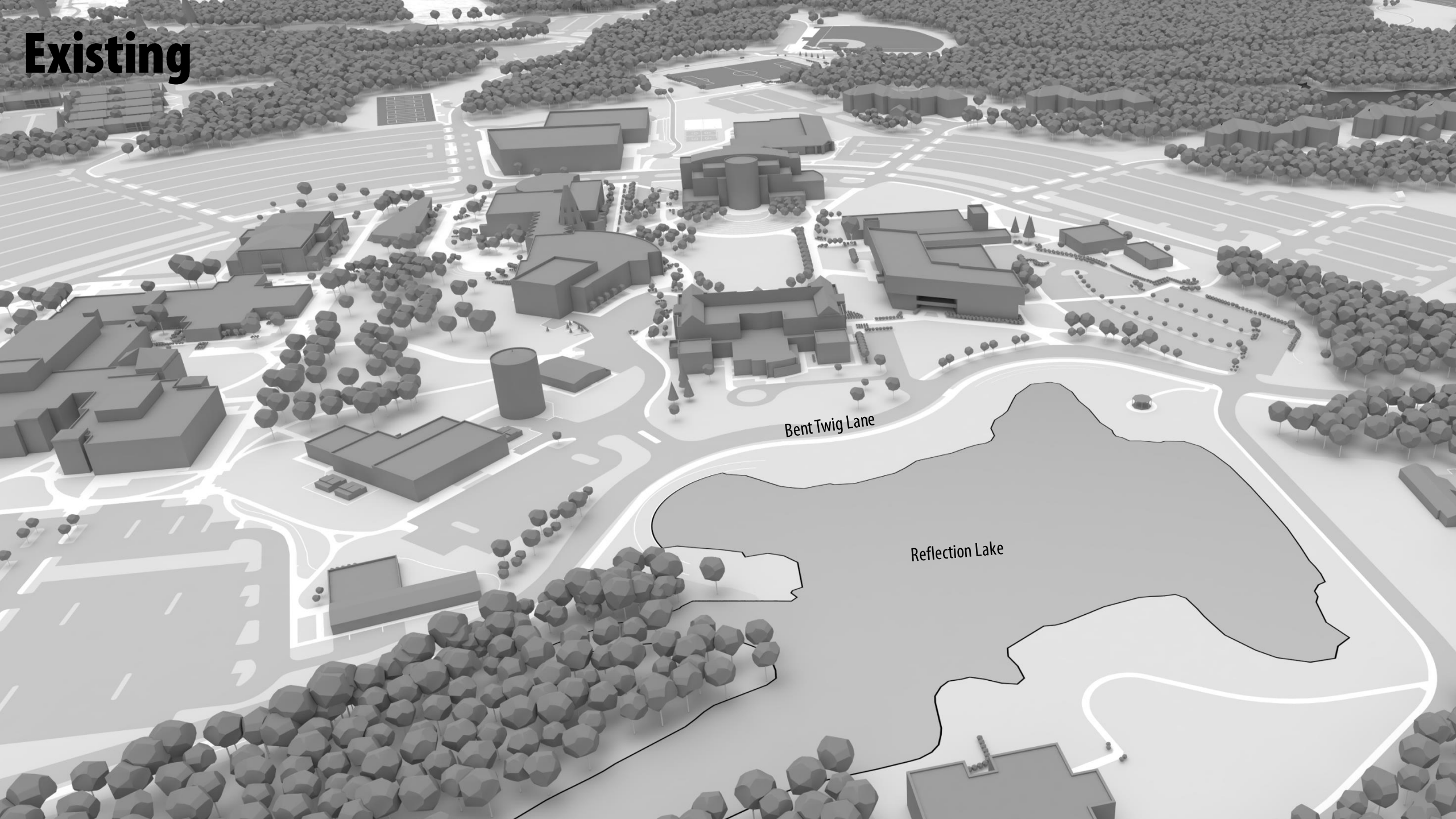

Bent Twig Lane

Reflection Lake

Proposed



Bent Twig Lane

Reflection Lake

Key Planning Themes

- 
- Elevate the quality of all support facilities.
 - Identify improved opportunities for collaboration.
 - Position student focused services in centralized locations.
 - Realize operational efficiencies where possible.

Improve Support Facilities

Improve Support Facilities

Proposed

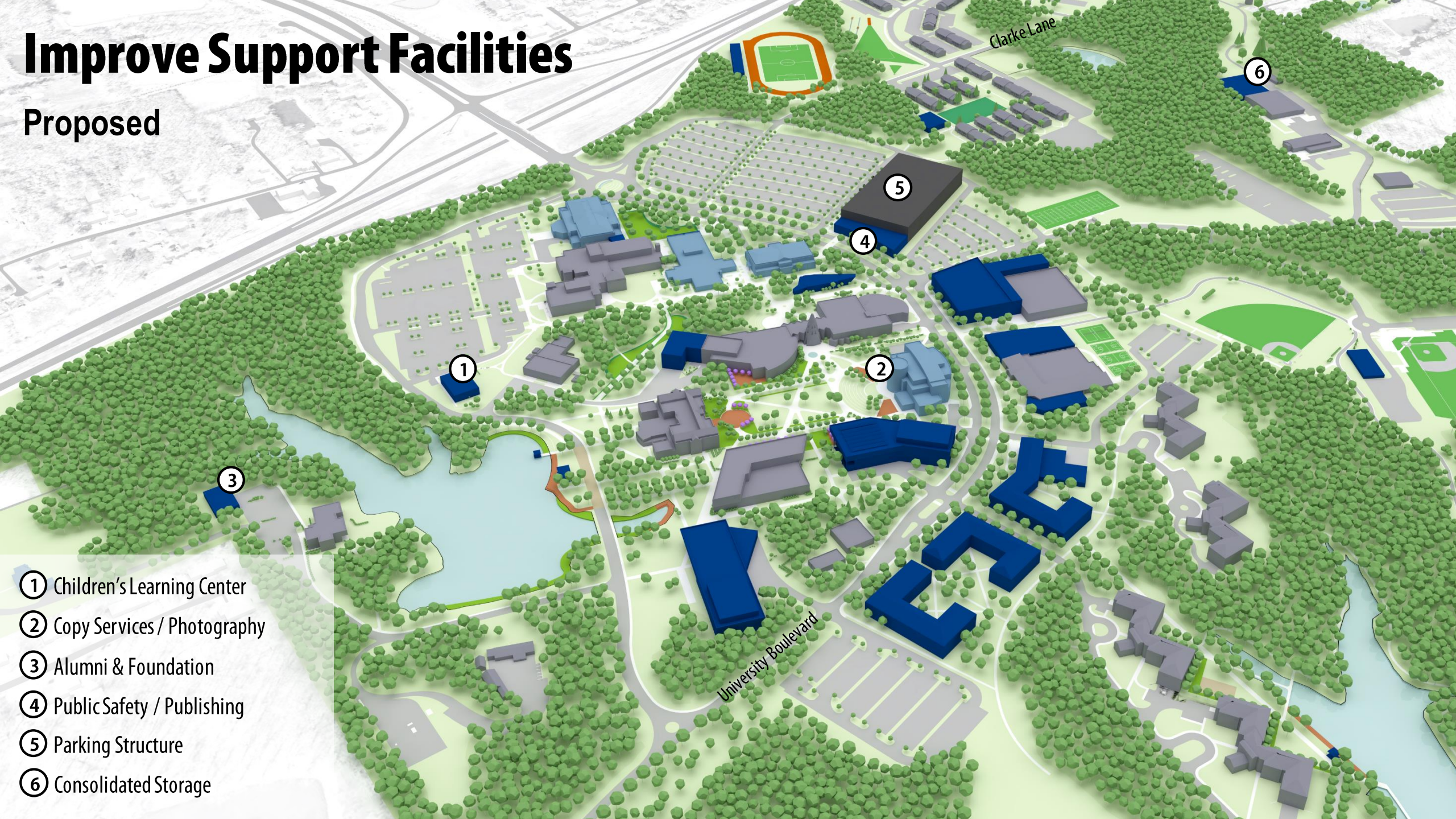

- ① Children's Learning Center
- ② Copy Services / Photography
- ③ Alumni & Foundation
- ④ Public Safety / Publishing
- ⑤ Parking Structure
- ⑥ Consolidated Storage

Phasing Matrix

Phase 0: Under Construction

1) Health Professions Center
(3rd Floor Renovation)

2) Welcome Center

3) PAC Expansion Phase I (Arena)

4) Rec Center Expansion
(Natatorium)

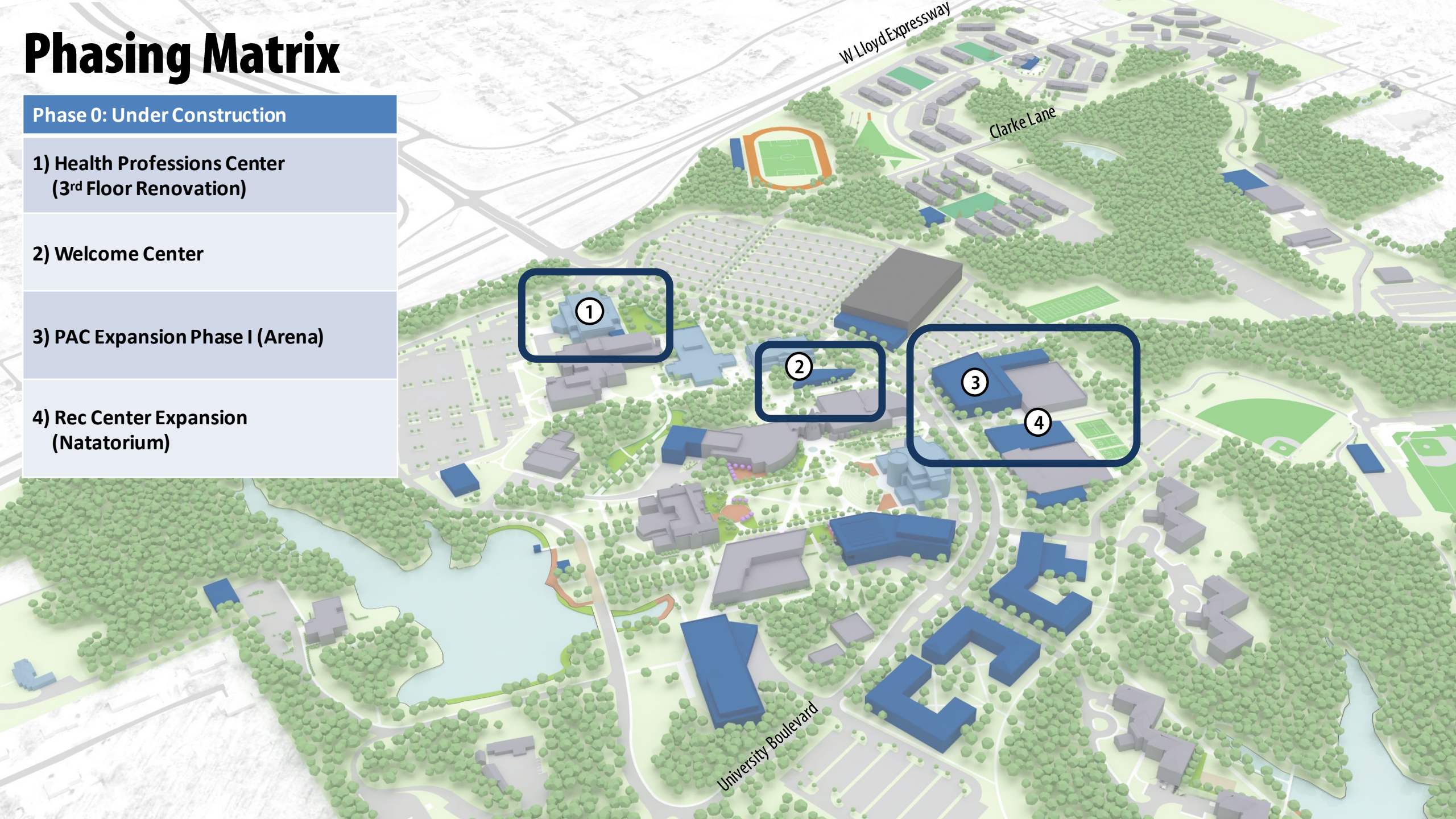

Phasing Matrix

Phase I: Near Term (0-6 Years)

- 1) Health Professions Center
(Full Building Renovation)
- 2) Health and Wellness Center
- 3) Parking Structure and Multi-Use Bldg
(Public Safety/Creative Services)
- 4) Residence Hall and Dining Commons
- 5) Fair Residence Life Center
(Dining Expansion)
- 6) Children's Learning Center
- 7) Nexus Innovation Center Ph I

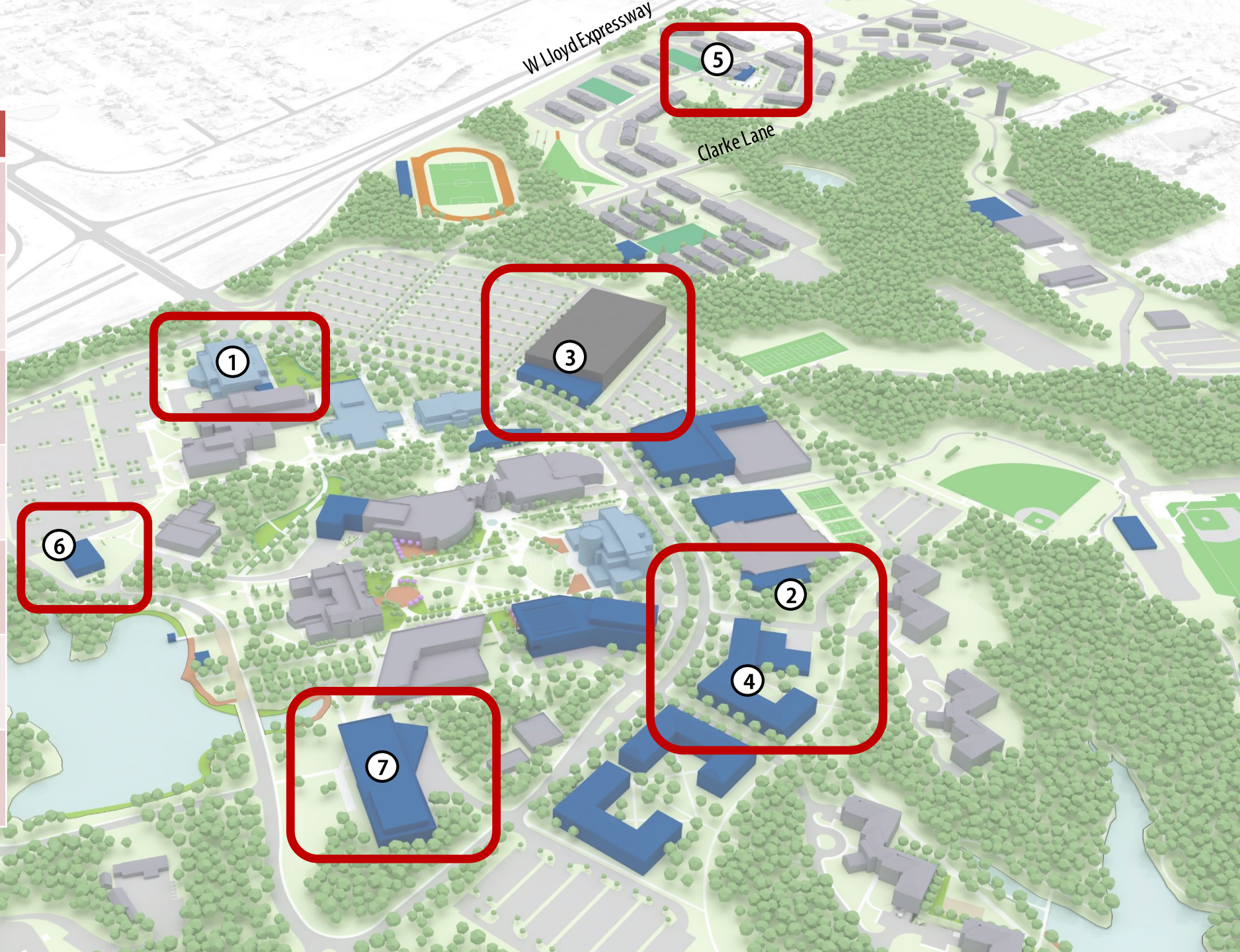

Thank you

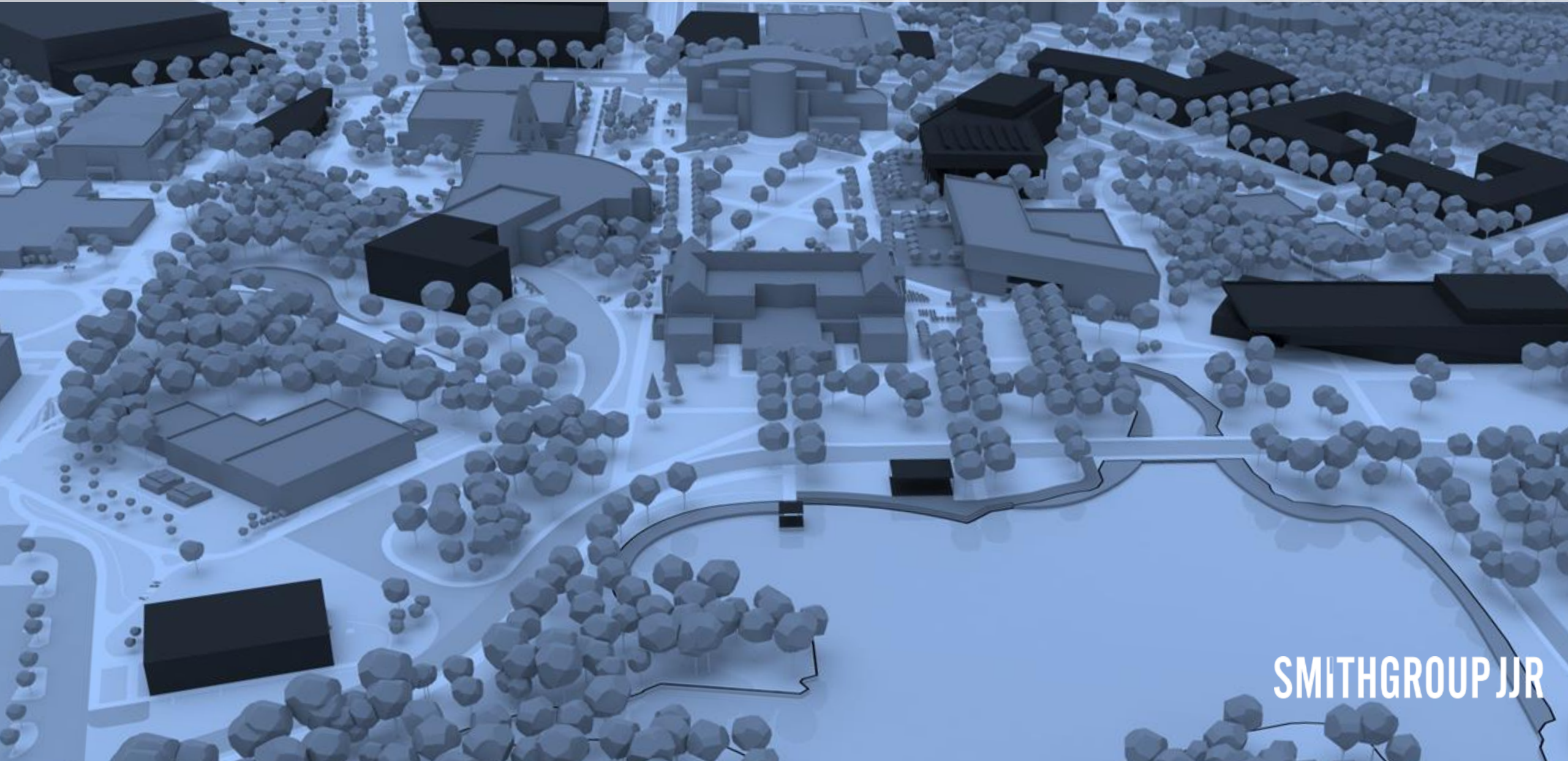

SMITHGROUP JJR